



*Internationally Recognized  
Technically Advanced  
Innovative Products*

INNOVATION ♦ RELIABILITY ♦ QUALITY ♦ PERFORMANCE ♦ INNOVATION ♦ RELIABILITY ♦ QUALITY ♦ PERFORMANCE ♦ INNOVATION ♦ RELIABILITY ♦ QUALITY ♦ PERFORMANCE

The background of the page is filled with various line-drawing illustrations of GTI products, including different types of ducts, couplers, and accessories, arranged in a scattered pattern.

# **GTI<sup>®</sup> POST-TENSIONING DUCT AND ACCESSORIES**



**GENERAL TECHNOLOGIES, INC.<sup>®</sup>**



# GTI® Round Plastic Duct

INNOVATION ♦ RELIABILITY ♦ QUALITY ♦ PERFORMANCE ♦ INNOVATION ♦ RELIABILITY ♦ QUALITY ♦ PERFORMANCE ♦ INNOVATION ♦ RELIABILITY ♦ QUALITY ♦ PERFORMANCE



Danube Bridge 2  
Vidin - Calafat

## Standard Round Plastic Duct

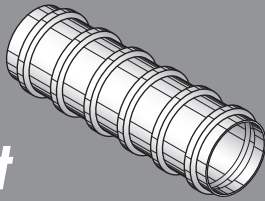

## Flow Channel Round Plastic Duct

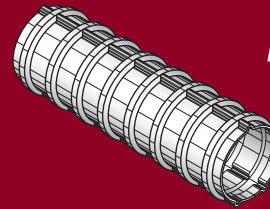

Size mm (in)	Part No. (P/N)	Nominal ID mm (in)	Nominal OD at Ribs mm (in)	Slip-On Coupler (P/N)	Nominal OD Coupler mm (in)
48 (1.89)	220150	48 (1.89)	59 (2.32)	220155	65 (2.56)
59 (2.32)	220200	59 (2.32)	73 (2.87)	220205	79 (3.11)
66 (2.60)	220250	66 (2.60)	81 (3.19)	220255	87 (3.43)
76 (3.00)	220300	76 (2.99)	91 (3.58)	220305	97 (3.82)
85 (3.35)	220360	85 (3.35)	100 (3.94)	220355	107 (4.21)
95 (3.75)	220950	95 (3.75)	111 (4.37)	220955	118 (4.65)
100 (4.00)	220408	100 (3.94)	116 (4.57)	220415	124 (4.88)
109 (4.30)	221440	109 (4.29)	126 (4.96)	221445	133 (5.24)
115 (4.50)	220458	115 (4.53)	135 (5.32)	220465	141 (5.55)
145 (5.70)	220550	145 (5.71)	168 (6.62)	220555	175 (6.89)
160 (6.20)	220590	158 (6.22)	181 (7.14)	220595	188 (7.40)

Size mm (in)	Part No. (P/N)	Nominal ID mm (in)	Nominal OD at Ribs mm (in)	Number of Flow Channels	Slip-On Coupler (P/N)	Nominal OD Coupler mm (in)
23 (0.90)	220800	23 (0.91)	37 (1.46)	2	220806	43 (1.69)
85 (3.35)	220350	85 (3.35)	100 (3.94)	3	220355	107 (4.21)
100 (4.00)	220410	100 (3.94)	116 (4.57)	3	220415	124 (4.88)
115 (4.50)	220460	115 (4.53)	135 (5.32)	3	220465	141 (5.55)
130 (5.13)	220500	128 (5.04)	151 (5.94)	4	220505	158 (6.22)

Please contact GTI Technical Representatives at [sales@gti-usa.net](mailto:sales@gti-usa.net) for more information.



# GTI® Flat/Oval Plastic Duct

INNOVATION ♦ RELIABILITY ♦ QUALITY ♦ PERFORMANCE ♦ INNOVATION ♦ RELIABILITY ♦ QUALITY ♦ PERFORMANCE ♦ INNOVATION ♦ RELIABILITY ♦ QUALITY ♦ PERFORMANCE



Novartis Building

## Flat and Oval Plastic Duct

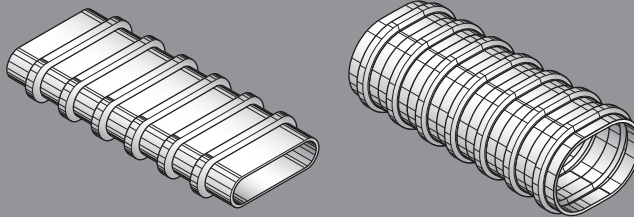

Size mm (in)	Part No. (P/N)	Nominal ID/Height mm (in)	Nominal ID/Width mm (in)	Nominal OD at Ribs mm (in)	Slip-On Coupler (P/N)	Nominal OD Coupler mm (in)
22 x 38 (0.85 x 1.50)	220700	22 (0.87)	38 (1.50)	36 x 52 (1.42 x 2.05)	220705	42 x 58 (1.66 x 2.29)
21 x 52 (0.83 x 2.05)	220190	21 (0.83)	52 (2.05)	35 x 66 (1.38 x 2.60)	220195	41 x 72 (1.62 x 2.84)
21 x 72 (0.83 x 2.83)	220100	21 (0.83)	72 (2.83)	35 x 86 (1.38 x 3.39)	220105	41 x 92 (1.62 x 3.63)
25 x 76 (1.00 x 3.00)	220600	25 (0.98)	76 (2.99)	39 x 90 (1.54 x 3.54)	220605	45 x 96 (1.78 x 3.78)
21 x 90 (0.83 x 3.54)	220900	21 (0.83)	90 (3.54)	35 x 104 (1.38 x 4.09)	220905	41 x 110 (1.62 x 4.33)
26 x 91 (1.02 x 3.58)	220910	26 (1.02)	91 (3.58)	40 x 105 (1.57 x 4.13)	220915	46 x 111 (1.81 x 4.37)
79 x 111 (3.10 x 4.40)	221420	79 (3.11)	111 (4.37)	96 x 128 (3.78 x 5.04)	221425	104 x 136 (4.10 x 5.36)

See [www.gti-usa.net/patents.shtml](http://www.gti-usa.net/patents.shtml) for a listing of many of the patents licensed to GTI, including patents that may cover one or more of the products identified.



# GTI® Accessories for Bonded Post-Tensioning

INNOVATION ♦ RELIABILITY ♦ QUALITY ♦ PERFORMANCE ♦ INNOVATION ♦ RELIABILITY ♦ QUALITY ♦ PERFORMANCE ♦ INNOVATION ♦ RELIABILITY ♦ QUALITY ♦ PERFORMANCE



- **FULL RANGE OF COUPLERS**

- Slip-On
- Stepless
- Snap-Lock
- Precast Segmental

- **GROUT HOSE**
- **HIGH-PRESSURE GROUT VALVES**
- **WELDED GROUT VENT PORTS**
- **CUSTOM GROUT CAPS**
- **CUSTOM TRUMPETS**
- **STRAND BULLETS**



**GENERAL TECHNOLOGIES, INC.®**

13022 Trinity Dr. • P.O. Box 1503 • Stafford, Texas 77477 • Tel: (281) 240-0550 • Fax: (281) 240-0990  
sales@gti-usa.net • www.gti-usa.net