



*Internationally Recognized  
Technically Advanced  
Innovative Products*

INNOVATION ♦ RELIABILITY ♦ QUALITY ♦ PERFORMANCE ♦ INNOVATION ♦ RELIABILITY ♦ QUALITY ♦ PERFORMANCE ♦ INNOVATION ♦ RELIABILITY ♦ QUALITY ♦ PERFORMANCE

# **GTI POST-TENSIONING DUCT AND ACCESSORIES**



**GENERAL TECHNOLOGIES, INC.<sup>®</sup>**



# GTI Round Plastic Duct

INNOVATION ♦ RELIABILITY ♦ QUALITY ♦ PERFORMANCE ♦ INNOVATION ♦ RELIABILITY ♦ QUALITY ♦ PERFORMANCE ♦ INNOVATION ♦ RELIABILITY ♦ QUALITY ♦ PERFORMANCE



Danube Bridge 2  
Vidin - Calafat

## Standard Round Plastic Duct

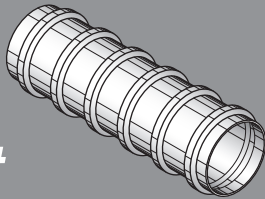

## Flow Channel Round Plastic Duct

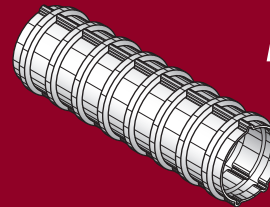

Size mm (in)	Part No. (P/N)	Nominal ID mm (in)	Nominal OD at Ribs mm (in)	Slip-On Coupler (P/N)	Nominal OD Coupler mm (in)
48 (1.89)	220150	48 (1.89)	59 (2.32)	220155	65 (2.56)
59 (2.32)	220200	59 (2.32)	73 (2.87)	220205	79 (3.11)
76 (3.00)	220300	76 (2.99)	91 (3.58)	220305	97 (3.82)
85 (3.35)	221350	85 (3.35)	100 (3.94)	220355	107 (4.21)
95 (3.75)	220370	95 (3.75)	111 (4.37)	220375	118 (4.65)
100 (4.00)	220400	100 (3.94)	116 (4.57)	220415	124 (4.88)
109 (4.30)	221440	109 (4.29)	126 (4.96)	221445	133 (5.24)
115 (4.50)	220450	115 (4.53)	135 (5.32)	220465	141 (5.55)
145 (5.70)	220550	145 (5.71)	168 (6.62)	220555	175 (6.89)
160 (6.20)	220590	158 (6.22)	181 (7.14)	220595	188 (7.40)

Size mm (in)	Part No. (P/N)	Nominal ID mm (in)	Nominal OD at Ribs mm (in)	Number of Flow Channels	Slip-On Coupler (P/N)	Nominal OD Coupler mm (in)
23 (0.90)	220800	23 (0.91)	37 (1.46)	2	220801	43 (1.69)
85 (3.35)	220350	85 (3.35)	100 (3.94)	3	220355	107 (4.21)
100 (4.00)	220410	100 (3.94)	116 (4.57)	3	220415	124 (4.88)
115 (4.50)	220460	115 (4.53)	135 (5.32)	3	220465	141 (5.55)
130 (5.13)	220500	128 (5.04)	151 (5.94)	4	220505	158 (6.22)

Contact GTI for more detailed information.



# GTI Flat/Oval Plastic Duct

INNOVATION ♦ RELIABILITY ♦ QUALITY ♦ PERFORMANCE ♦ INNOVATION ♦ RELIABILITY ♦ QUALITY ♦ PERFORMANCE ♦ INNOVATION ♦ RELIABILITY ♦ QUALITY ♦ PERFORMANCE



Novartis Building

## Flat and Oval Plastic Duct

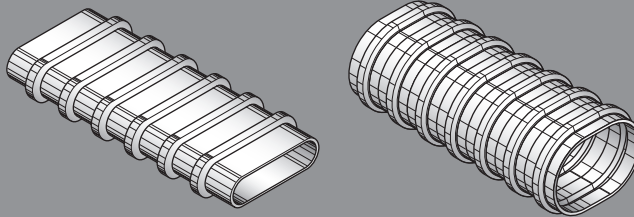

Size mm (in)	Part No. (P/N)	Nominal ID/Height mm (in)	Nominal ID/Width mm (in)	Nominal OD at Ribs mm (in)	Slip-On Coupler (P/N)	Nominal OD Coupler mm (in)
22 x 38 (0.85 x 1.50)	220700	22 (0.87)	38 (1.50)	36 x 52 (1.42 x 2.05)	220705	42 x 58 (1.66 x 2.29)
21 x 52 (0.83 x 2.05)	220190	21 (0.83)	52 (2.05)	35 x 66 (1.38 x 2.60)	220195	41 x 72 (1.62 x 2.84)
21 x 72 (0.83 x 2.83)	220100	21 (0.83)	72 (2.83)	35 x 86 (1.38 x 3.39)	220105	41 x 92 (1.62 x 3.63)
25 x 76 (1.00 x 3.00)	220600	25 (0.98)	76 (2.99)	39 x 90 (1.54 x 3.54)	220605	45 x 96 (1.78 x 3.78)
21 x 90 (0.83 x 3.54)	220900	21 (0.83)	90 (3.54)	35 x 104 (1.38 x 4.09)	220905	41 x 110 (1.62 x 4.33)
79 x 111 (3.10 x 4.40)	221420	79 (3.11)	111 (4.37)	96 x 128 (3.78 x 5.04)	221425	104 x 136 (4.10 X 5.36)

See [www.gti-usa.net/patents.shtml](http://www.gti-usa.net/patents.shtml) for a listing of many of the patents licensed to GTI, including patents that may cover one or more of the products identified.



# GTI Accessories for Bonded Post-Tensioning

INNOVATION ✦ RELIABILITY ✦ QUALITY ✦ PERFORMANCE ✦ INNOVATION ✦ RELIABILITY ✦ QUALITY ✦ PERFORMANCE ✦ INNOVATION ✦ RELIABILITY ✦ QUALITY ✦ PERFORMANCE



- **FULL RANGE OF COUPLERS**

- Slip-On
- Stepless
- Snap-Lock
- Precast Segmental

- **GROUT HOSE**
- **WELDED GROUT VENT PORTS**
- **CUSTOM GROUT CAPS**
- **CUSTOM TRUMPETS**
- **STRAND BULLETS**



**GENERAL TECHNOLOGIES, INC.®**



P.O. Box 1503  
13022 Trinity Drive  
Stafford, TX 77477  
Tel: (281) 240-0550

E-mail: [sales@gti-usa.net](mailto:sales@gti-usa.net)  
Website: [www.gti-usa.net](http://www.gti-usa.net)  
Fax: (281) 240-0990  
Toll-free: (888) 255-0440