



*Internationally Recognized
Technically Advanced
Innovative Products*

INNOVATION ♦ RELIABILITY ♦ QUALITY ♦ PERFORMANCE ♦ INNOVATION ♦ RELIABILITY ♦ QUALITY ♦ PERFORMANCE ♦ INNOVATION ♦ RELIABILITY ♦ QUALITY ♦ PERFORMANCE

The background of the central section features a collection of white line-art illustrations of various post-tensioning duct and accessory components, including straight duct sections, curved duct sections, and various types of couplers and connectors, arranged in a scattered pattern.

**GTI POST-TENSIONING
DUCT AND
ACCESSORIES**



GENERAL TECHNOLOGIES, INC.®



GTI Round Plastic Duct

INNOVATION ♦ RELIABILITY ♦ QUALITY ♦ PERFORMANCE ♦ INNOVATION ♦ RELIABILITY ♦ QUALITY ♦ PERFORMANCE ♦ INNOVATION ♦ RELIABILITY ♦ QUALITY ♦ PERFORMANCE



Danube Bridge 2
Vidin - Calafat

Standard Round Plastic Duct

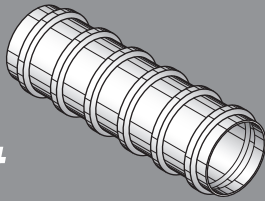

Flow Channel Round Plastic Duct

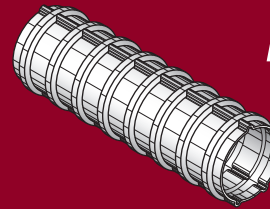

Size mm (in)	Part No. (P/N)	Nominal ID mm (in)	Nominal OD at Ribs mm (in)	Slip-On Coupler (P/N)	Nominal OD Coupler mm (in)
48 (1.89)	220150	48 (1.89)	59 (2.32)	220155	65 (2.56)
59 (2.32)	220200	59 (2.32)	73 (2.87)	220205	79 (3.11)
66 (2.60)	220250	66 (2.60)	81 (3.19)	220255	87 (3.43)
76 (3.00)	220300	76 (2.99)	91 (3.58)	220305	97 (3.82)
85 (3.35)	221350	85 (3.35)	100 (3.94)	220355	107 (4.21)
95 (3.75)	220370	95 (3.75)	111 (4.37)	220375	118 (4.65)
100 (4.00)	220400	100 (3.94)	116 (4.57)	220415	124 (4.88)
109 (4.30)	221440	109 (4.29)	126 (4.96)	221445	133 (5.24)
115 (4.50)	220450	115 (4.53)	135 (5.32)	220465	141 (5.55)
145 (5.70)	220550	145 (5.71)	168 (6.62)	220555	175 (6.89)
160 (6.20)	220590	158 (6.22)	181 (7.14)	220595	188 (7.40)

Size mm (in)	Part No. (P/N)	Nominal ID mm (in)	Nominal OD at Ribs mm (in)	Number of Flow Channels	Slip-On Coupler (P/N)	Nominal OD Coupler mm (in)
23 (0.90)	220800	23 (0.91)	37 (1.46)	2	220801	43 (1.69)
85 (3.35)	220350	85 (3.35)	100 (3.94)	3	220355	107 (4.21)
100 (4.00)	220410	100 (3.94)	116 (4.57)	3	220415	124 (4.88)
115 (4.50)	220460	115 (4.53)	135 (5.32)	3	220465	141 (5.55)
130 (5.13)	220500	128 (5.04)	151 (5.94)	4	220505	158 (6.22)

Please contact GTI Technical Representatives at sales@gti-usa.net for more information.



GTI Flat/Oval Plastic Duct

INNOVATION ♦ RELIABILITY ♦ QUALITY ♦ PERFORMANCE ♦ INNOVATION ♦ RELIABILITY ♦ QUALITY ♦ PERFORMANCE ♦ INNOVATION ♦ RELIABILITY ♦ QUALITY ♦ PERFORMANCE



Novartis Building

Flat and Oval Plastic Duct

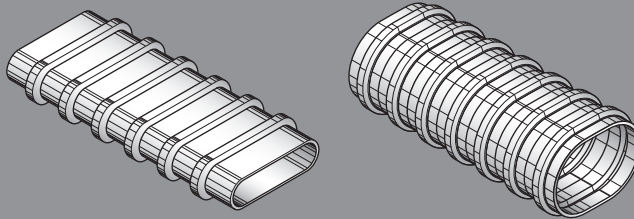

Size mm (in)	Part No. (P/N)	Nominal ID/Height mm (in)	Nominal ID/Width mm (in)	Nominal OD at Ribs mm (in)	Slip-On Coupler (P/N)	Nominal OD Coupler mm (in)
22 x 38 (0.85 x 1.50)	220700	22 (0.87)	38 (1.50)	36 x 52 (1.42 x 2.05)	220705	42 x 58 (1.66 x 2.29)
21 x 52 (0.83 x 2.05)	220190	21 (0.83)	52 (2.05)	35 x 66 (1.38 x 2.60)	220195	41 x 72 (1.62 x 2.84)
21 x 72 (0.83 x 2.83)	220100	21 (0.83)	72 (2.83)	35 x 86 (1.38 x 3.39)	220105	41 x 92 (1.62 x 3.63)
25 x 76 (1.00 x 3.00)	220600	25 (0.98)	76 (2.99)	39 x 90 (1.54 x 3.54)	220605	45 x 96 (1.78 x 3.78)
21 x 90 (0.83 x 3.54)	220900	21 (0.83)	90 (3.54)	35 x 104 (1.38 x 4.09)	220905	41 x 110 (1.62 x 4.33)
26 x 91 (1.02 x 3.58)	220910	26 (1.02)	91 (3.58)	40 x 105 (1.57 x 4.13)	220915	46 x 111 (1.81 x 4.37)
79 x 111 (3.10 x 4.40)	221420	79 (3.11)	111 (4.37)	96 x 128 (3.78 x 5.04)	221425	104 x 136 (4.10 X 5.36)

See www.gti-usa.net/patents.shtml for a listing of many of the patents licensed to GTI, including patents that may cover one or more of the products identified.



GTI Accessories for Bonded Post-Tensioning

INNOVATION ✦ RELIABILITY ✦ QUALITY ✦ PERFORMANCE ✦ INNOVATION ✦ RELIABILITY ✦ QUALITY ✦ PERFORMANCE ✦ INNOVATION ✦ RELIABILITY ✦ QUALITY ✦ PERFORMANCE



- **FULL RANGE OF COUPLERS**

- Slip-On
- Stepless
- Snap-Lock
- Precast Segmental

- **GROUT HOSE**
- **HIGH-PRESSURE GROUT VALVES**
- **WELDED GROUT VENT PORTS**
- **CUSTOM GROUT CAPS**
- **CUSTOM TRUMPETS**
- **STRAND BULLETS**



GENERAL TECHNOLOGIES, INC.®

13022 Trinity Dr. • P.O. Box 1503 • Stafford, Texas 77477
Tel: (281) 240-0550 • Fax: (281) 240-0990 • sales@gti-usa.net • www.gti-usa.net